

We are a highly skilled team backed by Romania's leading construction company. We develop premium residential projects in central Bucharest - comprising origination, structuring & analysis to design, build and exit.

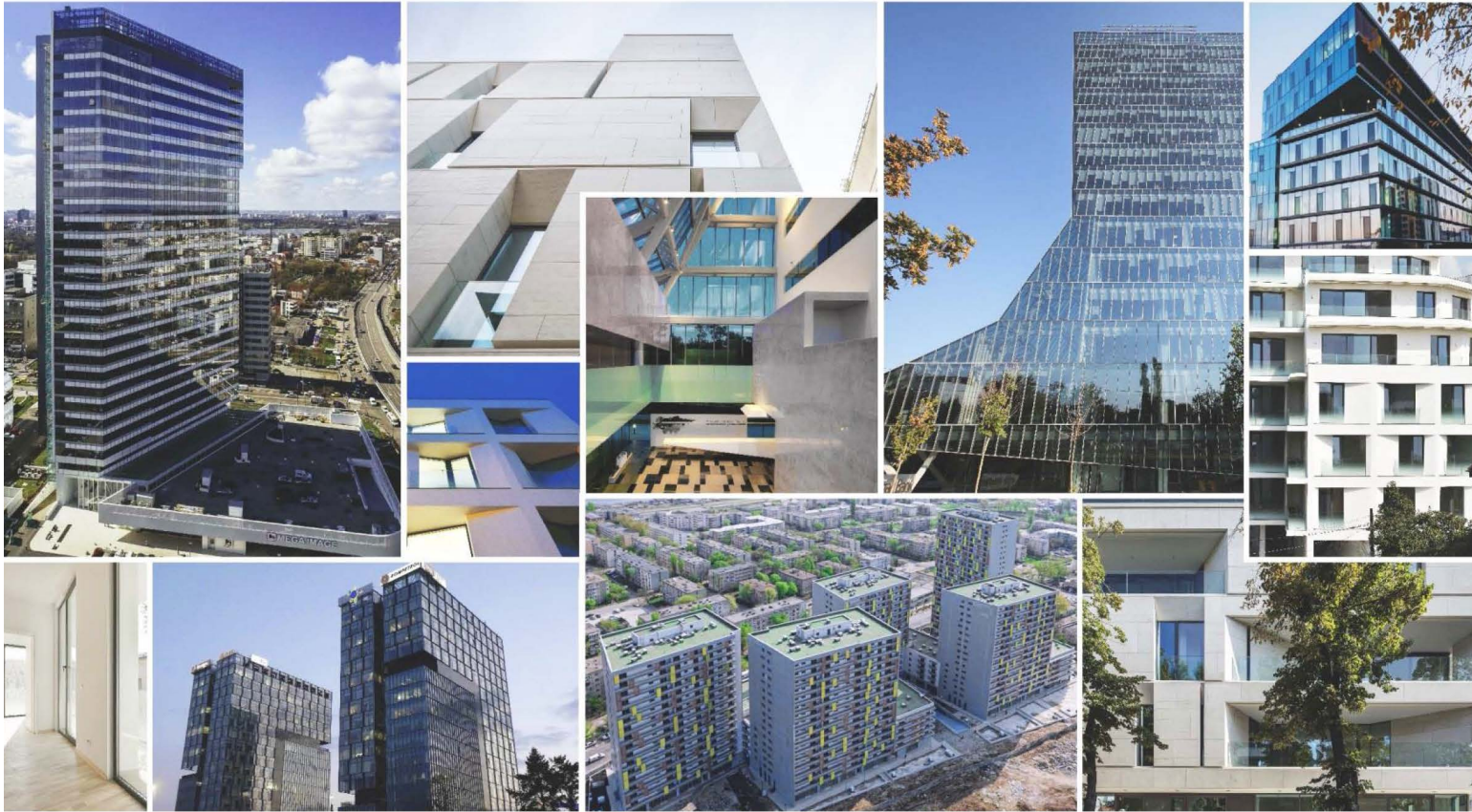

### Who we are

- Development division of Bog'Art, the largest Romanian construction company
- 26 years of activity, 600+ projects delivered with over 3million sqm contracted at €1.6bn
- Integrated platform: planning & design, production, execution, building management

### What we do

- Develop landmark buildings in central Bucharest: residential and selectively mixed use
- Well-positioned properties within walking distance to schools, shops, and public transport
- Premium units targeting young urban professionals in mid to upper-tier segment

### Project Type

- High spec buildings with modern design and facilities: parking, doorman, terraces
- 30-100 units with standout features; well-partioned with attention to detail
- 50-100sqm per unit, priced from €99,000 (0% VAT) to €250,000+VAT

### Parameters

- Project by project basis with outright land purchase or partnership
- Equity per project: €2-10mm, partly contributed by Bog'Art
- Investment Period: 2-3 years from land acquisition

### Current Developments

- [www.cismigiuhouse.ro](http://www.cismigiuhouse.ro) - 27 premium units near Cismigiu Park - 6,500sqm completed
- Mantuleasa Street - 70 urban apartments near city center - 10,000sqm in permitting
- Vitan Complex - mixed-use development - 24,000sqm in planning phase

